



Adams County Courthouse Renovation

Built in 1955, the Adams County courthouse sits prominently at the top of Davis Avenue complimenting Corning's business district. Over the last 70 years, as the building has aged, the courthouse no longer meets the needs of the county. The building does not meet ADA requirements. Community services such as the treasurer and board of supervisors' offices are located out of the way on the second floor. Additionally, the County law enforcement area within the courthouse is inadequate, inmates currently walk through public spaces on their way to court, and there are no private areas for attorneys to consult with clients.

After an extensive study of the building, the Board of Supervisors has determined that a renovation is the most cost effective solution to address the following issues:

- Remove asbestos
- Improve inefficient heating and cooling system
- Improve accessibility and comply with ADA requirements
- Create a secure space for law enforcement and separate circulation areas for inmates
- Address technology needs
- Move public offices to the first floor

These renovations will cost \$8,500,000 dollars. In order to pay for the improvements to the courthouse to ensure it can serve our county for the next 70 years, the Board of Supervisors has elected to employ a reverse property tax bond of \$.63 cents per \$1,000 of assessed property valuation. The impact will be minimal - as low as an additional \$33.26 a year for a house assessed at \$100,000 - as demonstrated by these charts:

Residential							
Assessed value	Rollback	Taxable value	Homestead credit	Net taxable value	Est. Tax Levy Increase	Monthly tax change	Annual tax change
\$100,000	56.4094%	\$56,409	\$4,000	\$52,409	\$0.63	\$2.77	\$33.26

Commercial					
Assessed value	Rollback	Taxable value	Est. Tax Levy Increase	Monthly tax change	Annual tax change
\$150,000	90.0000%	\$135,000	\$0.63	\$7.14	\$85.68

Agricultural Land					
Assessed value	Rollback	Taxable value	Est. Tax Levy Increase	Monthly tax change	Annual tax change
\$1,900/acre	84.0305%	\$1,597/acre	\$0.63	\$0.08/per acre	\$1.01/per acre





Adams County Courthouse Renovation

Ground Floor Plan Concept



Key Improvements

- 1 The building is expanded south by one full bay to accommodate the county space needs.
- 2 The central stair is removed to provide access/ circulation between the east and west sides of the building within the ground floor. It also allows the main entrance to be brought back to the center of the building, creating a symmetrical façade, and allowing for one main public lobby, and a centrally located elevator.
- 3 The sheriff's office has a secure ADA accessible vestibule off the main lobby.
- 4 The sheriff has secure and separate circulation from the public, and inmates have a secure route to the elevators for court hearings.
- 5 New ADA accessible male and female restrooms are added to meet code requirements. This allows the county to maintain access to the ground floor during after hour functions.
- 6 The Treasurer and Board of Supervisors is relocated to the ground floor for easier access by the public, as both of these offices have the highest interaction with the public.
- 7 There are three conference types provided, one directly off of the vestibule for public video conference, one interview room with a secure circulation path for inmates and one 6-person conference room with access from the main lobby and sheriff's corridor that can be utilized by the county and sheriff.
- 8 Dispatch has visibility into the vestibule, proximity to the kitchenette, direct access to the servers and their own restroom nearby
- 9 The new sheriff office space gives room for current and future growth. The offices are grouped together towards the front of the building, to be closer to the jail and to utilize natural daylighting.
- 10 More support spaces and room for storage have been added to accommodate the jail and sheriffs' needs.
- 11 The addition also provides space for election storage for the county. Preventing the need for off-site storage.
- 12 New mechanical and electrical systems provided to serve updated systems in the building. New VRF system provided in all office spaces to accommodate and update heating and cooling systems.



Adams County Courthouse Renovation

First Floor Plan Concept

KEY			
	Office - County		Storage
	Veterans Affairs		Conference
	Break Room		Mechanical/ Electrical Data
	Office		

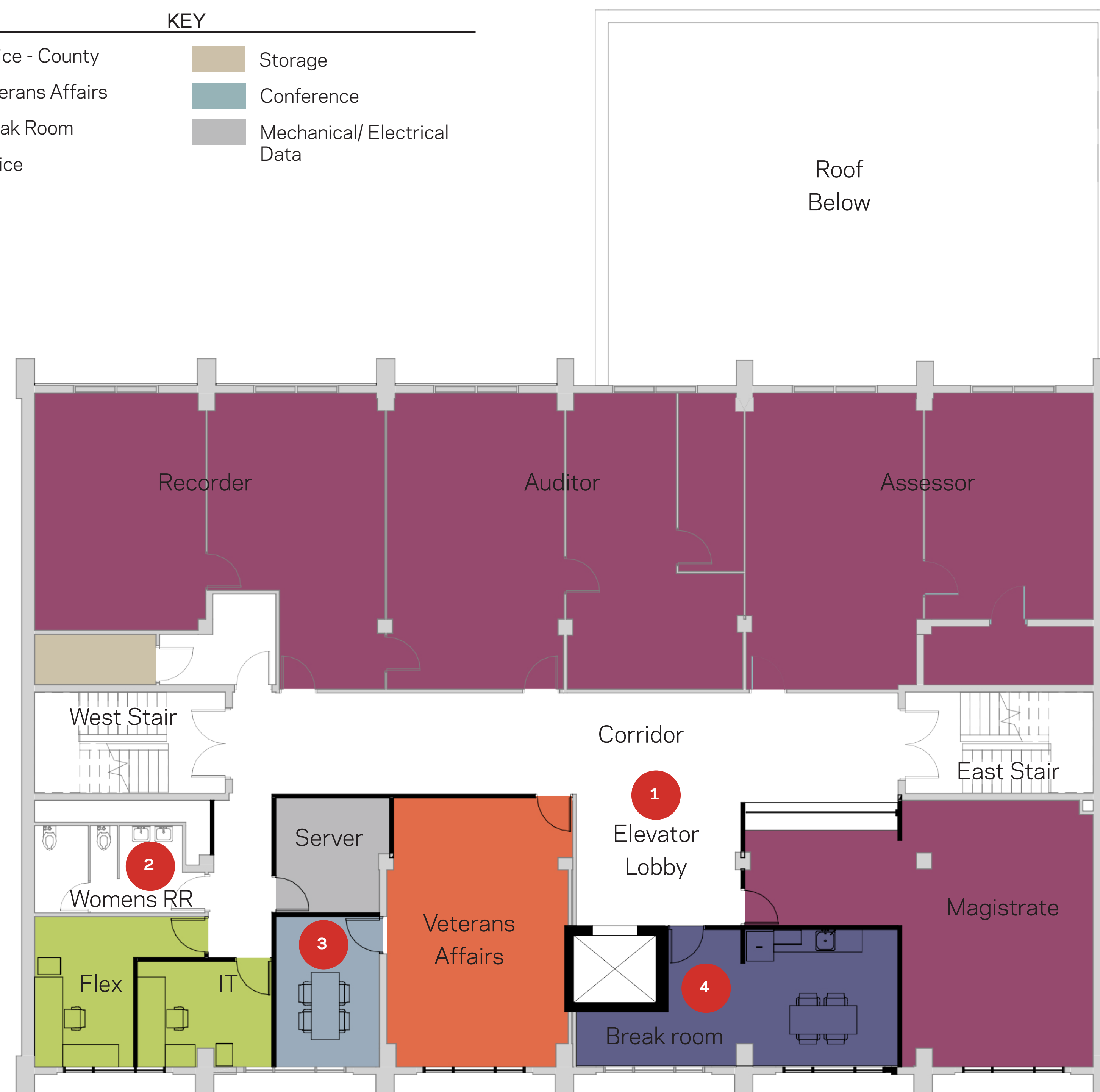

Key Improvements

- 1 The elevator is centrally located and has a lobby.
 - 2 Restrooms will be modified to accommodate ADA guidelines.
 - 3 The Board of Supervisors room moving to the first floor allows for more space for IT and a conference room for Veteran's Affairs, while creating a flex space for the county.
 - 4 Removing the main central stair allows for a break room for county employees.
- New VRF system provided in all office spaces to accommodate and update heating and cooling systems.



Adams County Courthouse Renovation

Second Floor Plan Concept

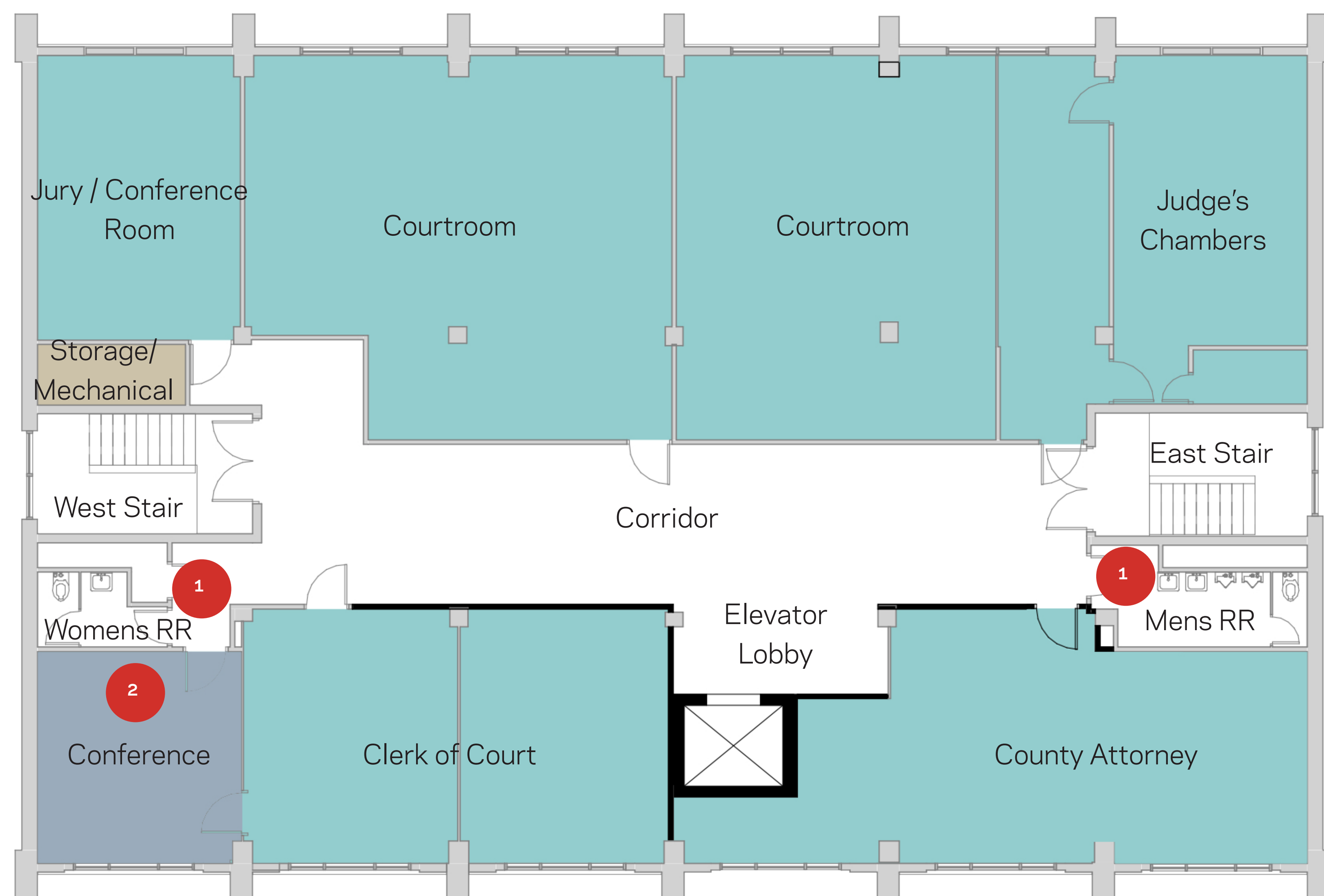
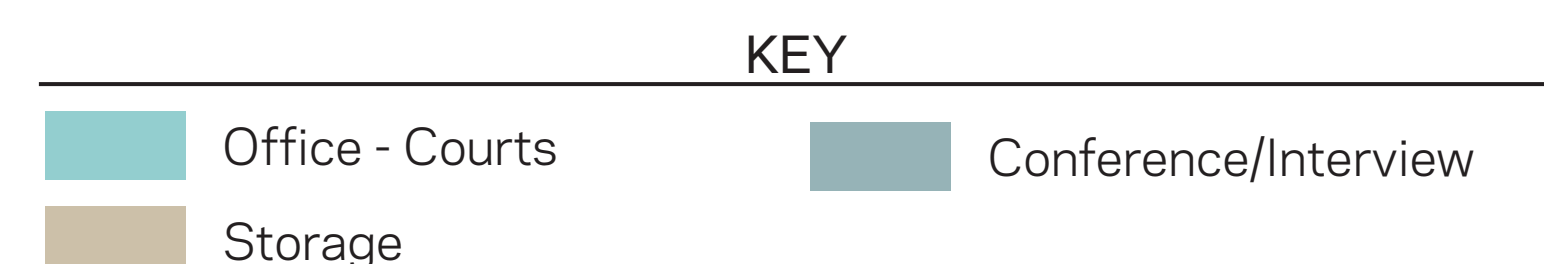

Key Improvements

- 1 Mens and womens restrooms modified to accommodate ADA guidelines.
- 2 Add additional conference room for private conversations/ meetings related to courtroom activities.

New VRF system provided in all office spaces to accommodate and update heating and cooling systems.